

Magglamp Halogen-50 Machine Light Spec Sheet

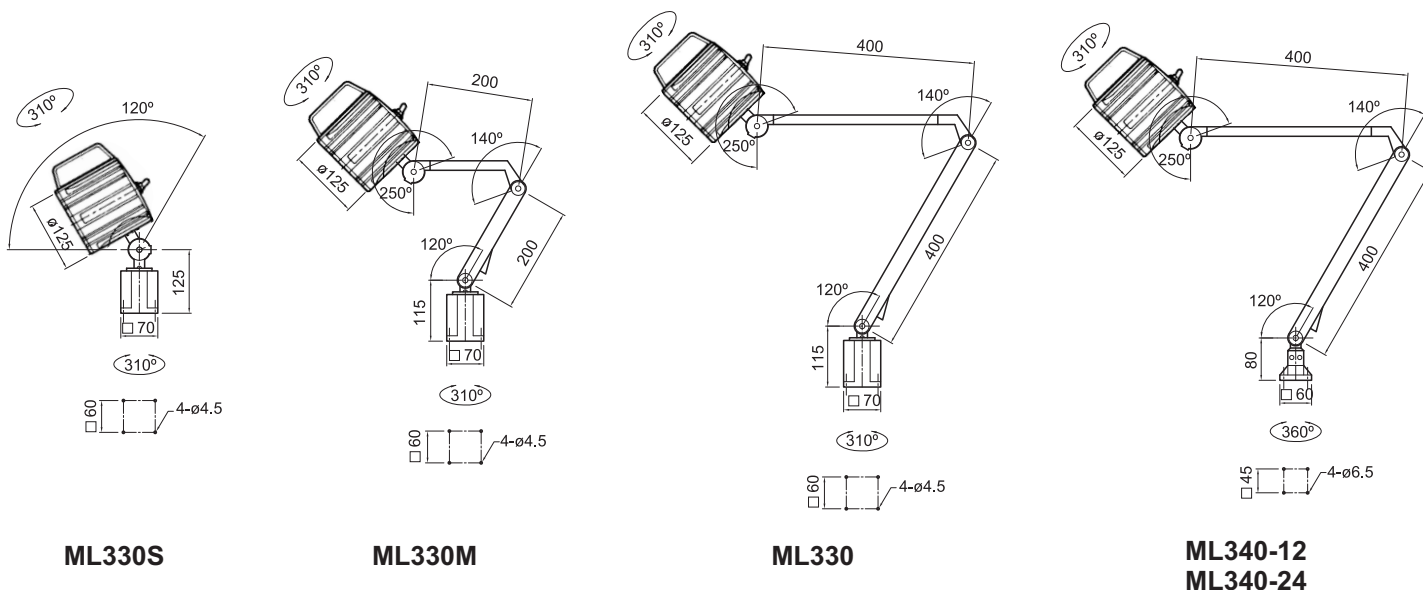

| | |
|-----------------------------|---|
| Fitted with | 1 x halogen GU 6.35 globe |
| Work equipment | Integrated 240 to 12V transformer (<i>ML330 Series only</i>) |
| Connected load | 240V 50/60Hz(<i>ML330 Series</i>), 12 or 24V AC/DC(<i>ML340 Series</i>) |
| Power consumption | approx. 50 Watt |
| Light output | 800 lumen |
| System of protection | IP 65 lamp head |
| Class of protection | I(240V) to III(12/24V) |
| Operation | switch on head |
| Lamp body | aluminium |
| Lamp cover | glass screen |
| Arm section | articulated aluminium tube arms, anodised grey |
| Base housing | black plastic (<i>ML330 Series</i>), cast aluminium (<i>ML340 Series</i>) |
| Weight | approx. 2-3kg |
| Power lead | approx. 1.8; mains plug AUS/NZ(<i>ML330 series only</i>) |
| Fastening | screw down flange, table clamp (accessory), wall bracket (accessory) |
| Accessory | - |
| Special features | 60° beam angle, 2800K colour temperature |

DIMENSIONS (Millimetres)



ML330S

ML330M

ML330

ML340-12
ML340-24

Data may vary due to component tolerances.
E & OE