



cryo systems

MC-150 CRYOSET

instructions for use

MC-150 CRYOSET

(350/500cc) liquid nitrogen unit



CE 1984

MC-150 Technical Specifications

MC-150 Cryo set has an ergonomic design. MC-150 Cryo set, which is easy to use and safe, ensures secure liquid nitrogen transfer by means of its large mouth structure. About 1 minute after the transfer of liquid nitrogen inside it, it becomes ready for intervention. With its secure trigger and escape valve system, it safely sprays liquid nitrogen in atomized droplets without clogging. MC-150 Cryo set is resistant to corrosion and breakage owing to its body that is produced using chrome – nickel material. Apart from standard accessories supplied with MC-150 Cryo set, a wide range of optional contact and spray tips with different diameters and sizes are available.

MC-150 Operating Manual



It can be used only in control of an experienced doctor!

CE 1984



R.01[[MC-150 CRYOSET]]

- MC-150 CRYOSET has been designed for use in dermatological treatments.
- MC-150 CRYOSET's steel body and spray trigger part are manufactured in a way to protect the user from cold.
- The device is ready to use in 45-60 seconds after filling process. The device can be refilled after each use. (Liquid nitrogen capacity: 0.5 lt. / Empty weight: 0.60 kg. / Full weight: 0.90 kg. / Static standby time: 20 hours)

CRYOMED

Tel : +90-312-278 19 46
Fax : +90-312-278 23 46
iletisim@bimedcryo.com
www.bimedcryo.com

- Preferred spray or contact tip; Probe tip is connected to the holder part by turning it clockwise. Spray and contact probe tips can be easily screwed by hand and prevent leakage. (They should not be connected with a force that makes it difficult to remove them again.)

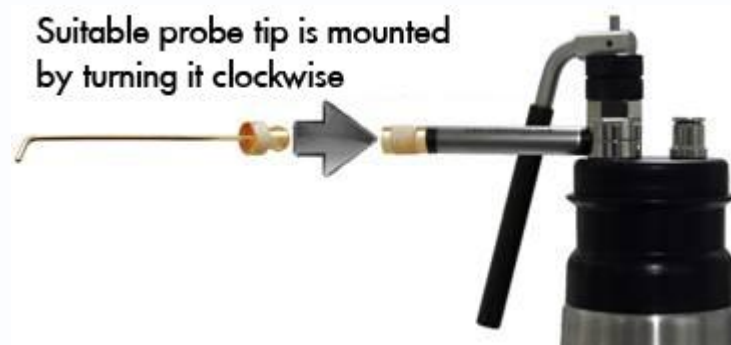

R.02[[MC-150 Probe tip mounting]]

- Trigger adjustment nuts must be in the upper position for use.

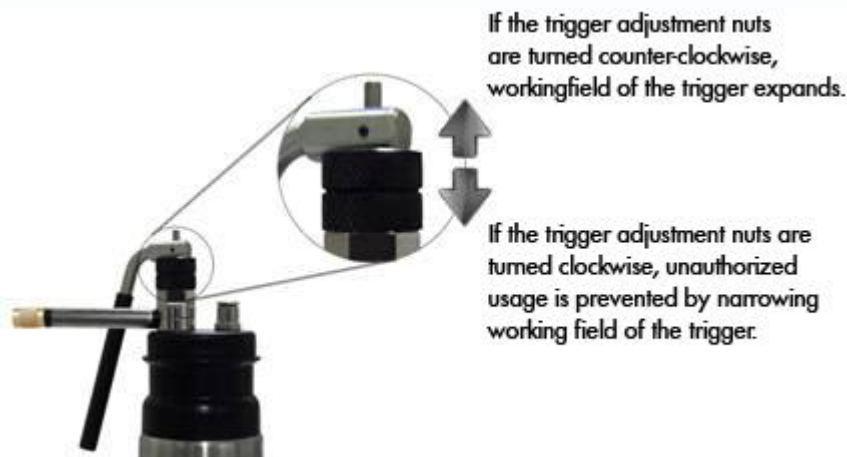

R.03[[MC-150 Trigger Adjustment Nuts]]

- Pressing the trigger, liquid nitrogen is sprayed in the form of atomized droplets towards the location of application



R.04[[MC-150 Application]]

- Pressure in the MC-150 steel tank constantly increases due to evaporation. Said pressure also gives rise to a mechanical force which in turn operates the device. In order to ensure a stable operation of the system, an escape and discharge valve are included. In case intra-tank pressure reaches the limit of 750 mB (+/- 10%), said valve opens the system and discharges the evaporated nitrogen. This process continues as long as there is liquid nitrogen in MC-150. (MC-150 CRYOSET is manufactured using stainless steel material with high tensile strength.)



R.05[[MC-150 Escape and Discharge Valve]]

- After being filled with liquid nitrogen and becoming ready to use, MC-150 can be applied for maximum 10-12 hours (static standby time for 60% full condition). After this period, the liquid nitrogen in the MC-150 tank will evaporate and get out of the system by its nature depending on the ambient conditions.
- After application, the trigger adjustment nuts can be locked by turning them counter-clockwise and bringing to lower position and unauthorized usage can be completely prevented.

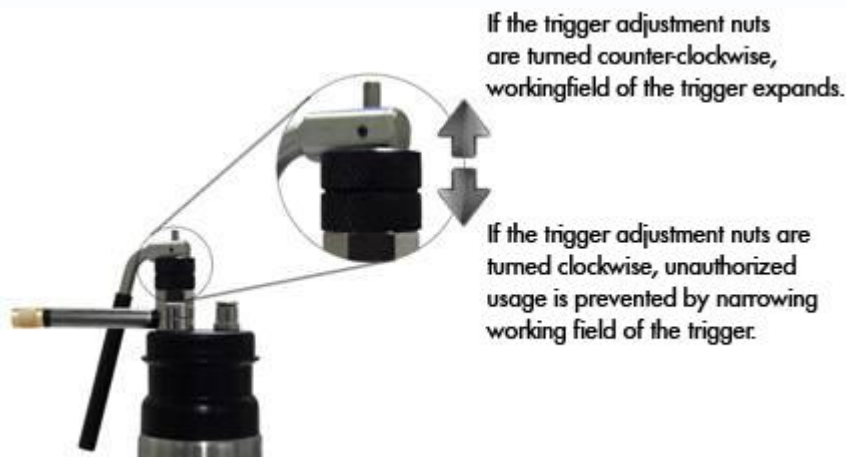

R.06[[MC-150 Trigger Adjustment Nuts]]



- In case of any inconvenience related to device use, CRYOMED technical service should be contacted.



- Information on the label must be observed during use.

FILLING LIQUID NITROGEN



R.07[[MC-150 CRYOSET steel body]]



R.08[[20 lt. liquid nitrogen container]]

- Together with MC-150 CRYOSET, 20 lt. liquid nitrogen tank and nitrogen transfer unit are provided. (Static waiting period for liquid nitrogen tank is 220 days.)
- MC-150 CRYOSET can be used by a qualified personnel trained for liquid nitrogen fill.
- Liquid nitrogen transfer unit is connected to the liquid nitrogen tank mechanically. Tension springs are attached to carrying handles. Pressure on the transfer unit is regulated through automatic (4psi-6psi) and manual discharge valves by discharging the pressure before pressure reaches danger limit. (Pressure in the tank can be seen on the pressure manometer located on the transfer unit.)



R.09[[Transfer unit tension springs and tank capped valve]]

CE 1984

CRYOMED

Tel : +90-312-278 19 46
Fax : +90-312-278 23 46
iletisim@bimedcryo.com
www.bimedcryo.com

- MC-150 CRYOSET top cap is opened by turning it counter-clockwise.
- As liquid nitrogen is an unstable liquid, filling it directly by hand is inconvenient. It is likely to be encountered with bubbling and splashing situations in the meanwhile. In order to perform filling process in a safe manner, a liquid nitrogen transfer unit should be used. The filter in the transfer unit tap prevents possible splashes.



R.10[[Liquid Nitrogen tank and transfer unit]]



R.11[[Liquid Nitrogen filling process]]

CE 1984

CRYOMED

Tel : +90-312-278 19 46

Fax : +90-312-278 23 46

iletisim@bimedcryo.com

www.bimedcryo.com

- The filling process is performed up to about 60% of the steel container.



R.12[[MC-150 CRYOSET steel body]]

- Nitrogen transfer valve is opened by turning it counter-clockwise and it is closed by turning it clockwise when filling process is performed.

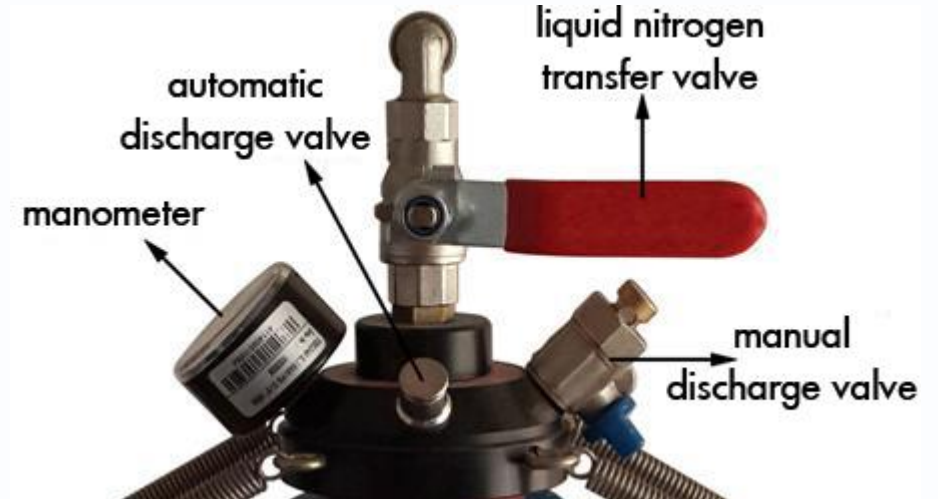

R.13[[Likit Nitrojen aktarma ünitesi]]

- Liquid nitrogen transfer unit should not be disassembled until liquid nitrogen in the tank runs out to prevent evaporation loss.
- For disassembling transfer unit, manual discharge valve is opened by turning it counter-clockwise and it is waited until manometer is reset to zero. The transfer unit can be disassembled after manometer is reset.

CE 1984

CRYOMED

Tel : +90-312-278 19 46
Fax : +90-312-278 23 46
iletisim@bimedcryo.com
www.bimedcryo.com



SPRAY TIPS

Manufactured with four different hole diameters as A, B, C, D for lesions in various sizes.
(Gold-plated)



CONICAL SPRAY TIPS

Manufactured with four different hole diameters as A, B, C, D for lesions in various sizes.
(Gold-plated)



LONG SPRAY TIPS

Manufactured in different diameters and lengths as flat and curved modes for lesions that cannot be accessed with short spray nozzles.
(Gold-plated)
(16-18-20 G)



LUER-LOCK ADAPTOR

Manufactured to use disposable surgical needles in Cryo treatment.
(Gold-plated)



CRYO CHAMBER

Manufactured in different diameters to cause tissue destruction by pool effect in deep lesions.
(Gold-plated)

ACCESSORIES



SUPER SPRAY TIP

Performs faster and uninterrupted spraying on lesions by means of its super thin hole and returns.
(Gold-plated)



VENT-BACK ADAPTOR

Eliminates interrupted spraying and increases liquid nitrogen flow.
(Gold-plated)

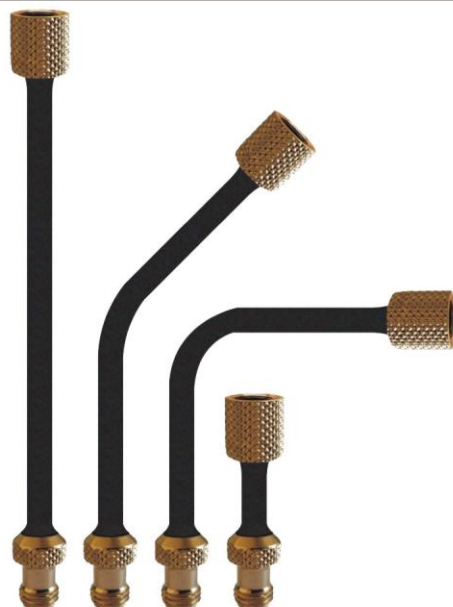

EXTENSION ADAPTORS

Used to change and extend spraying angle.
Suitable for all spray and contact probe tips.
(Gold-plated)



CRYO PLATES

Used as tissue limiter in aesthetic Cryo applications.
(1.5 - 3 - 5 - 8 mm)



CRYO PLATES

Used as tissue limiter in Cryo applications in large lesions.
(10 - 12 - 15 - 18 mm)

CE 1984

CRYOMED

Tel : +90-312-278 19 46
Fax : +90-312-278 23 46
iletisim@bimedcryo.com
www.bimedcryo.com

ACCESSORIES



CONTACT PROBES

Provides treatment opportunity by contacting lesions.

Available in diameters between 0.5 - 25 mm
(Gold-plated)

CE 1984



CERVICAL PROBES

Available in various sizes for gynecological interventions
(Gold-plated)

CRYOMED

Tel : +90-312-278 19 46
Fax : +90-312-278 23 46
iletisim@bimedcryo.com
www.bimedcryo.com

ACCESSORIES

CE 1984



**LIQUID NITROGEN (LN2) STORAGE - HANDLING
and TRANSFER EQUIPMENT**

1 - 3 - 6 - 10 - 20 - 30 - 35 - 50 - lt.

CRYOMED

Tel : +90-312-278 19 46

Fax : +90-312-278 23 46

iletisim@bimedcryo.com

www.bimedcryo.com



Warnings

- In case of any inconvenience related to device use, CRYOMED technical service should be contacted.
- Information on the label must be observed during use.
- MC-150 CRYOSET does not require periodic maintenance.
- In case of possible malfunction, intervention of unauthorized people is not covered by the warranty.
- Please use the original packaging during transportation.

Cleaning & Maintenance

- Substances on the device, all contact and spray cryo probes should be cleaned with a damp cloth after each use. Moreover, after cleaning that the device and probes should be disinfected with a medical device disinfectant.

Warranty Terms

- 1-) Warranty period starts from the date of delivery and it is for 2 (two) years.
- 2-) The entire good including all of its components is under the warranty of our company.
- 3-) Within the warranty period, in case of malfunction due to either material or labor or installation failures, the product will be repaired without charging any fee for labor cost, cost of the replaced part or under any other name.
- 6-) Failures due to wrong use of products, contrary to the instructions stated in the manual are not covered in the warranty scope.

CE 1984

CRYOMED

Tel : +90-312-278 19 46

Fax : +90-312-278 23 46

iletisim@bimedcryo.com

www.bimedcryo.com

ERTAN DEMİRKOLLU - CRYOMED BIOMEDİKAL CİHAZLAR

İMALAT İTHALAT İHRACAT SANAYİ VE TİCARET

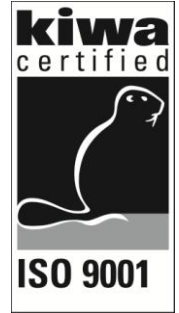

adres : Yeşilçam İşyeri Sitesi E Blok No:118 Etimesgut Ankara / Turkey
telefon : +90 312 278 1946 (pbx)
faks : +90 312 278 2346

CRYOMED

Tel : +90-312-278 19 46
Fax : +90-312-278 23 46
iletisim@bimedcryo.com
www.bimedcryo.com